

Temperature: -40°F to 180°F, silicone filled.

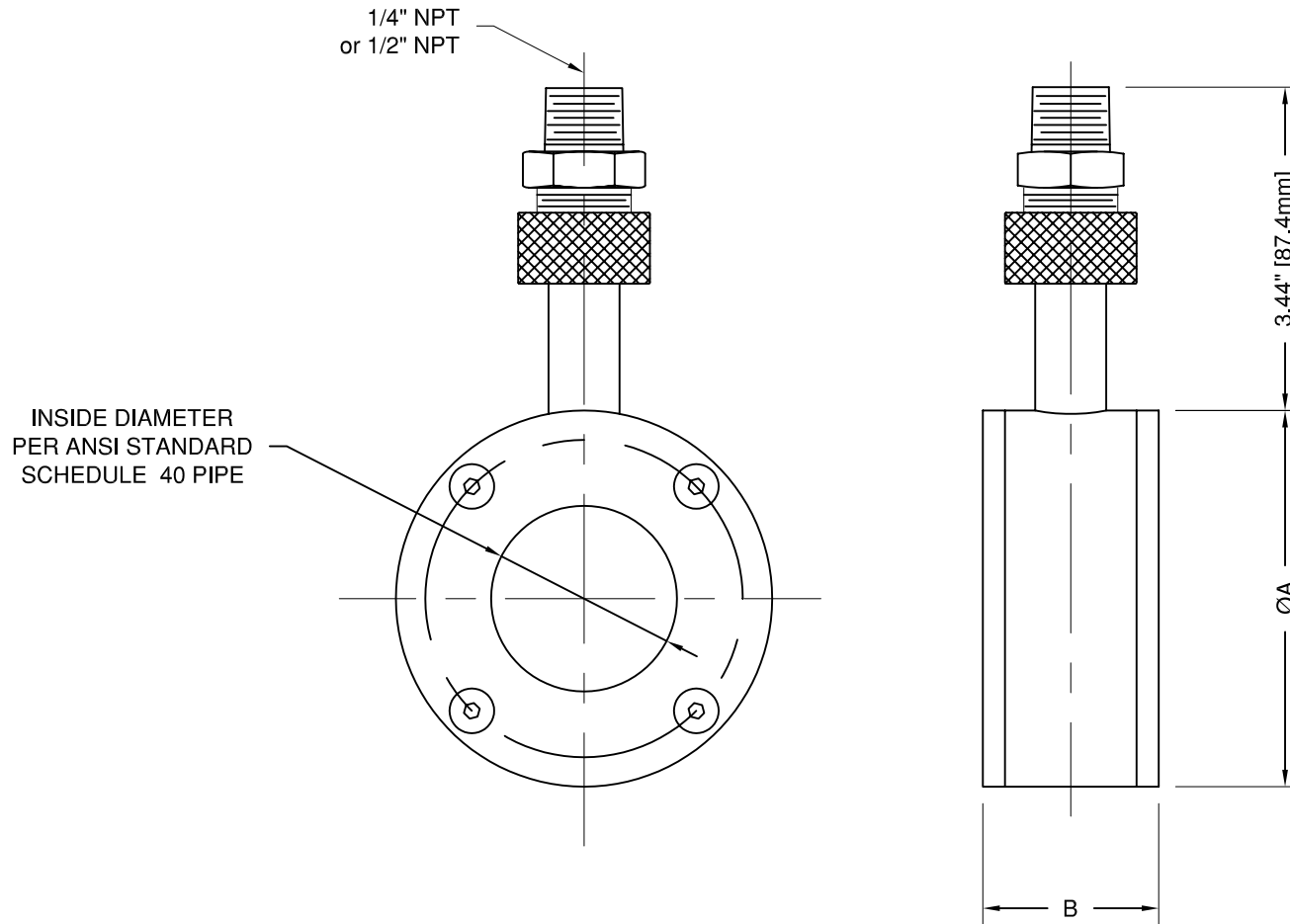

SIZE	ØA	B
1	2.50" [63.5mm]	1.87"[47.5mm]
1 1/2	3.25" [82.6mm]	1.87"[47.5mm]
2	4.00" [101.6mm]	1.87"[47.5mm]
2 1/2	4.75" [120.7mm]	1.87"[47.5mm]
3	5.25" [133.4mm]	1.87"[47.5mm]
4	6.75" [171.5mm]	2.12"[53.8mm]
5	7.62" [193.5mm]	2.25"[57.2mm]
6	8.62" [218.9mm]	2.25"[57.2mm]
8	10.87" [276.1mm]	2.25"[57.2mm]
10	13.25" [336.6mm]	2.81"[71.4mm]
12	16.00" [406.4mm]	3.12"[79.2mm]
14	17.62" [447.5mm]	3.12"[79.2mm]
16	20.12" [511.0mm]	3.12"[79.2mm]
18	21.50" [546.1mm]	3.12"[79.2mm]
20	23.75" [603.3mm]	3.12"[79.2mm]
24	32.00" [812.8mm]	3.12"[79.2mm]



DRAWN BY: T.S.
 CHECKED BY:
 ENG. APPROVAL:
 APPROVED BY:

ALL DIMENSIONS IN INCHES / MM
 TOLERANCES
 (unless otherwise stated)
 Fractional: 1/64" .4mm
 Decimal: 0.06" 1.5mm
 REVISION No. & DATE: (1) FEB. 19, 2004

TITLE:
ISOLATOR RING
 DRAWING NO: AC-ISOLATOR

Material Housing: PVC.
 Diaphragm: Teflon.
 Operating Pressure: Vacuum / 200 psi
 Operating temperature: 25°C / 40°C (77°F / 104°F).

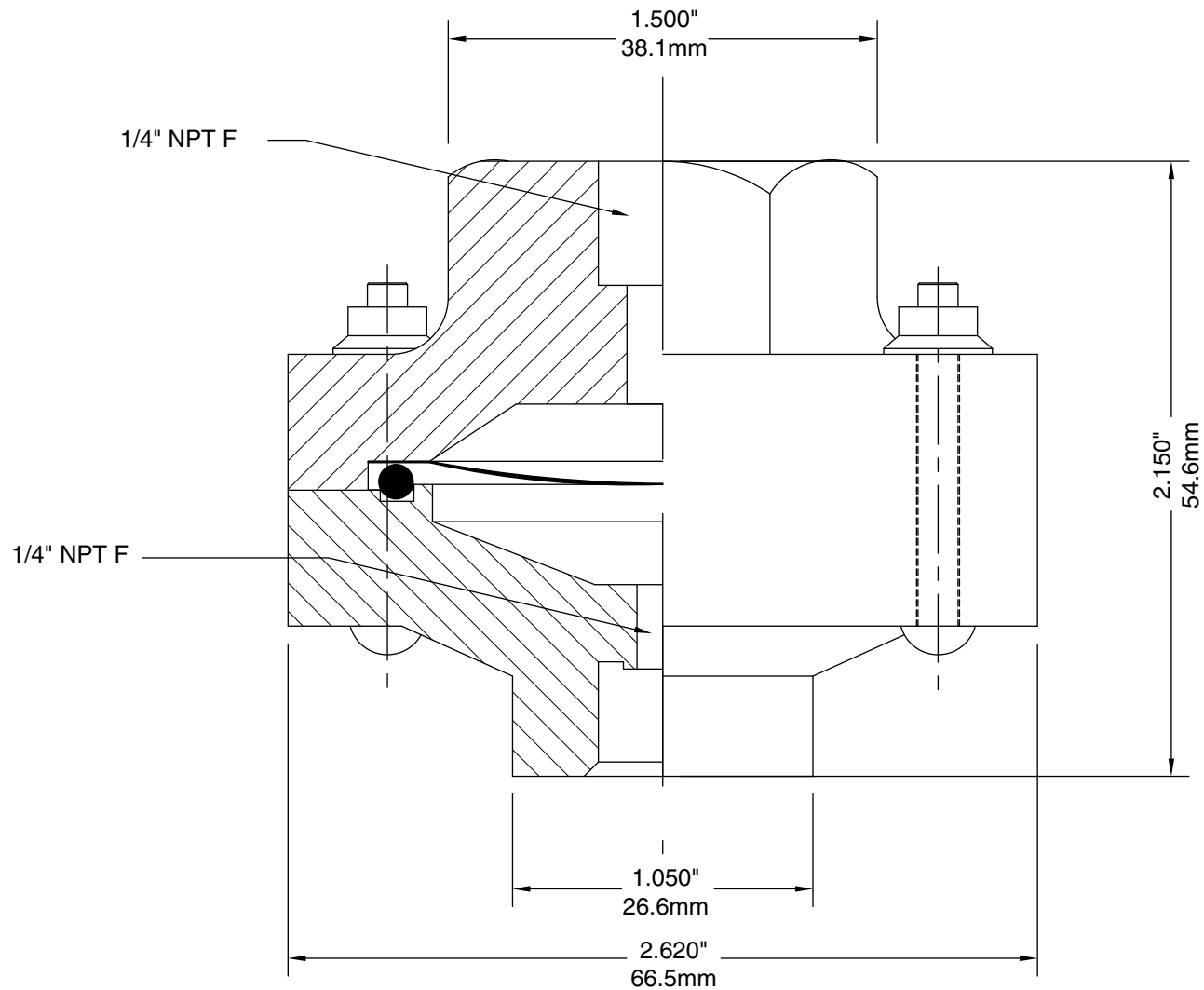

WINTERS INSTRUMENTS

DRAWN BY: E. H.

CHECKED BY:

ENG. APPROVAL:

APPROVED BY:

ALL DIMENSIONS IN INCHES

TOLERANCES
(unless otherwise stated)

Fractional: 1/64"

Decimal: 0.06"

REVISION No. & DATE: APR 5 2002

TITLE:

DIAPHRAGM SEAL #10

DRAWING NO: DS-10

Material Housing: 316 stainless steel.
 Diaphragm Material: 316L stainless steel.
 Welded construction
 Operating Pressure: 50 / 2000 psi.
 Operating Temperature: -31°C / 360°C (-20°F / 185°F).

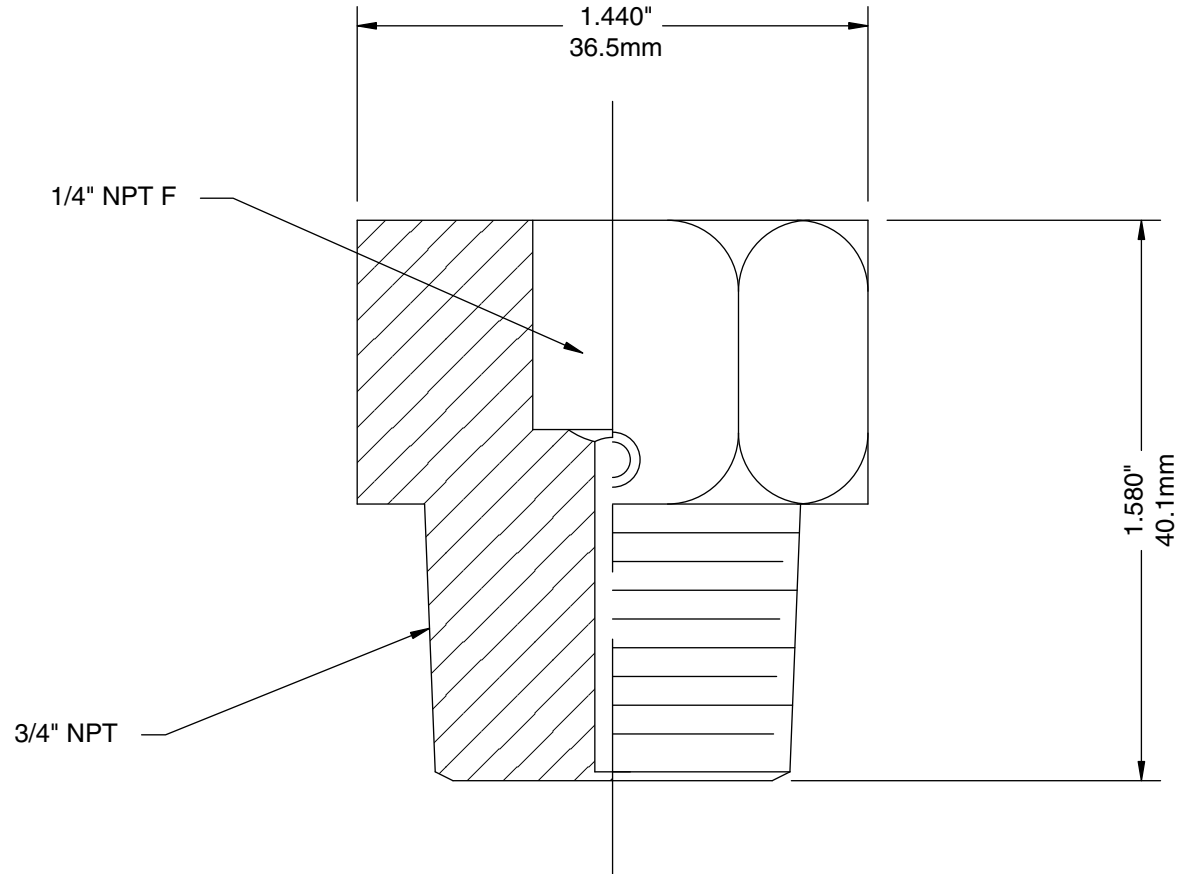

WINTERS INSTRUMENTS

DRAWN BY: E. H.

CHECKED BY:

ENG. APPROVAL:

APPROVED BY:

ALL DIMENSIONS IN INCHES

TOLERANCES
(unless otherwise stated)

Fractional:	1/64"
Decimal:	0.06"

REVISION No. & DATE: APR. 5 2002

TITLE:

DIAPHRAGM IN LINE #15 - LOW PRESSURE

DRAWING NO: DS-15-LOW

Material Housing: 316 stainless steel.
 Diaphragm Material: 316L stainless steel.
 Welded construction
 Operating Pressure: 600 / 5800 psi.
 Operating Temperature: -45°C / 150°C (-49°F / 302°F).

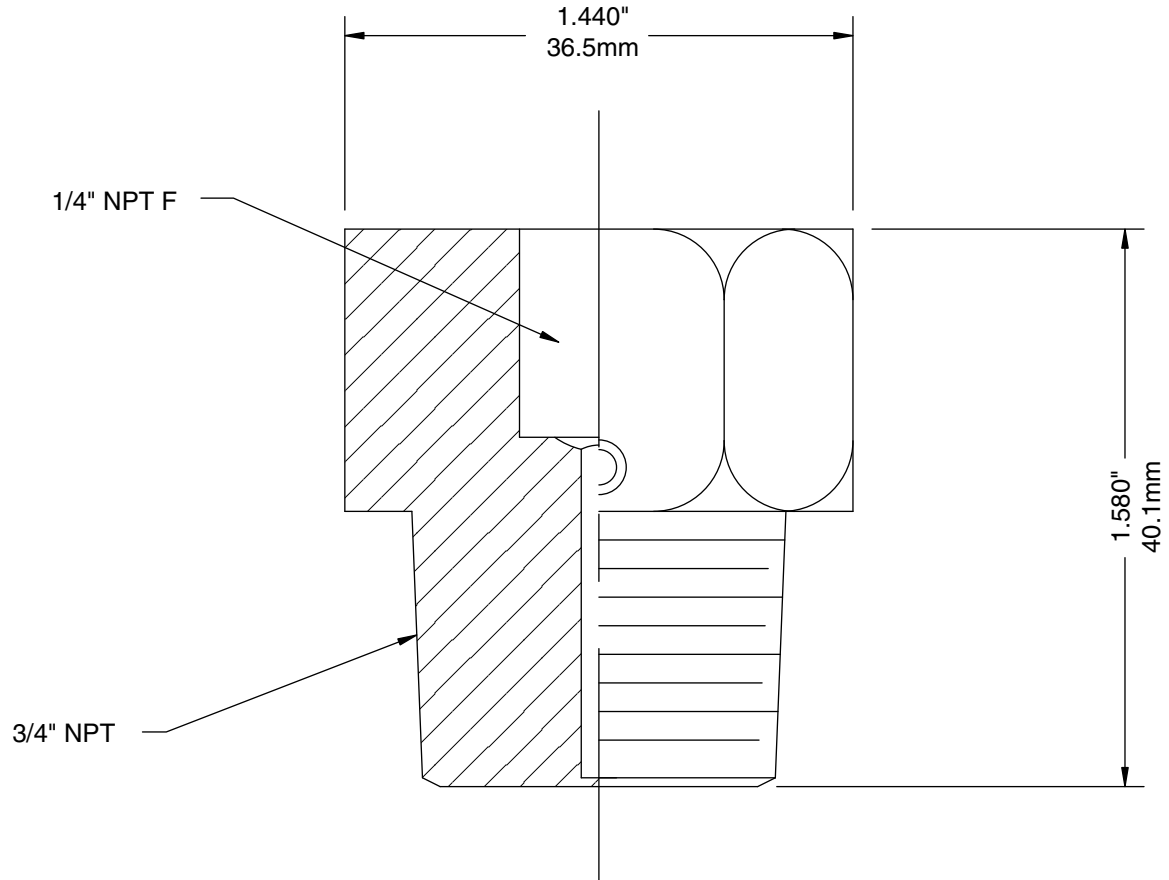

WINTERS INSTRUMENTS

DRAWN BY: E. H.
 CHECKED BY:
 ENG. APPROVAL:
 APPROVED BY:

ALL DIMENSIONS IN INCHES
 TOLERANCES
 (unless otherwise stated)
 Fractional: 1/64"
 Decimal: 0.06"
 REVISION No. & DATE: APR. 5 2002

TITLE:
 DIAPHRAGM IN LINE #15 - STANDARD PRESSURE
 DRAWING NO: DS-15-STD

Housing Material: 316 stainless steel.

Diaphragm Material: 316L stainless steel, welded.

Operating Pressure: 30 / 1000 psi.

Operating Temperature: -20°C / 120°C (-4°F / 248°F).

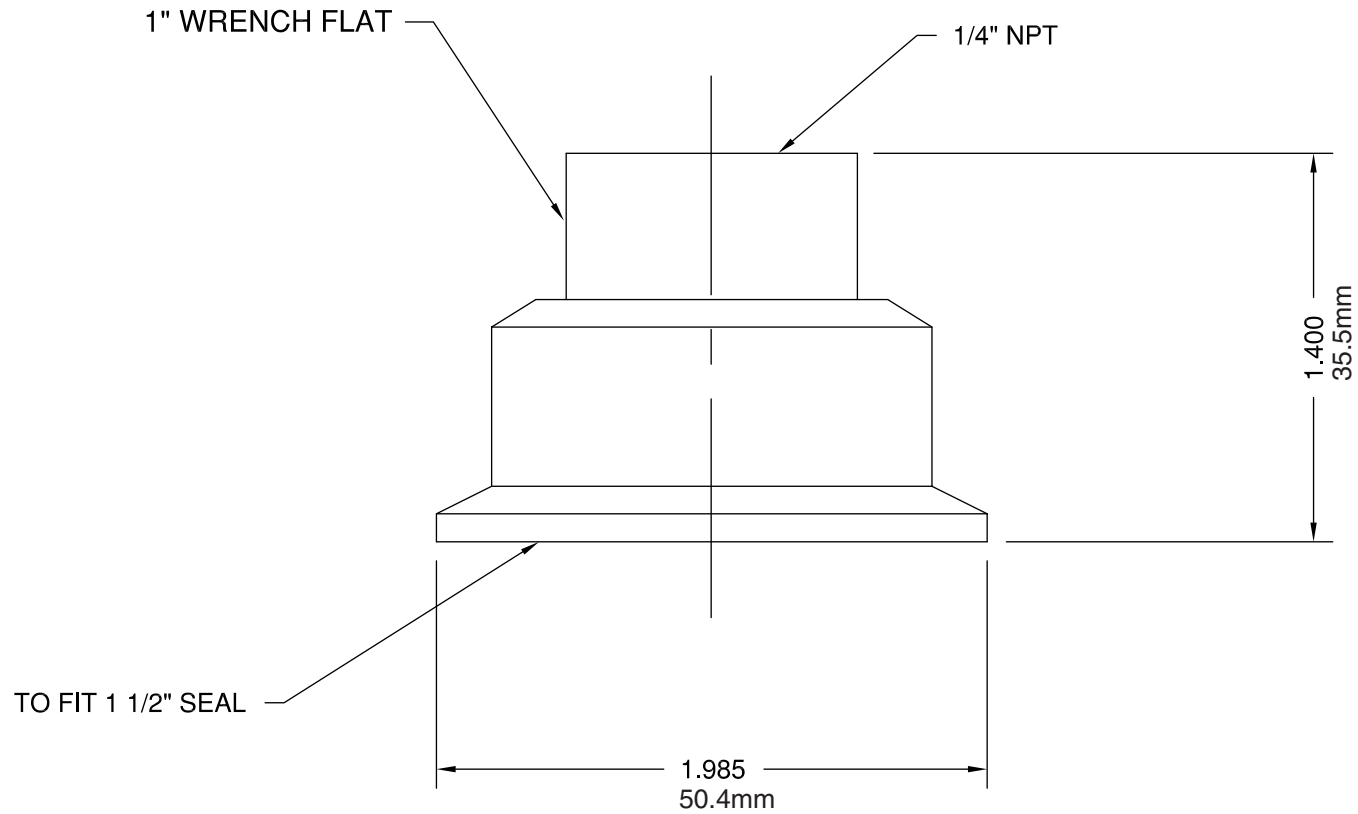

WINTERS INSTRUMENTS

DRAWN BY: E. H.

CHECKED BY:

ENG. APPROVAL:

APPROVED BY:

ALL DIMENSIONS IN INCHES

TOLERANCES
(unless otherwise stated)

Fractional:

1/64"

Decimal:

0.06"

REVISION No. & DATE: APR. 5 2002

TITLE:

DIAPHRAGM SEAL #20, 1.5" TRI-CLAMP

DRAWING NO: DS-20-1.5

Housing Material: 316 stainless steel.

Diaphragm Material: 316L stainless steel, welded.

Operating Pressure: 30 / 1000psi

Operating Temperature: -20°C / 120°C (-4°F / 248°F).

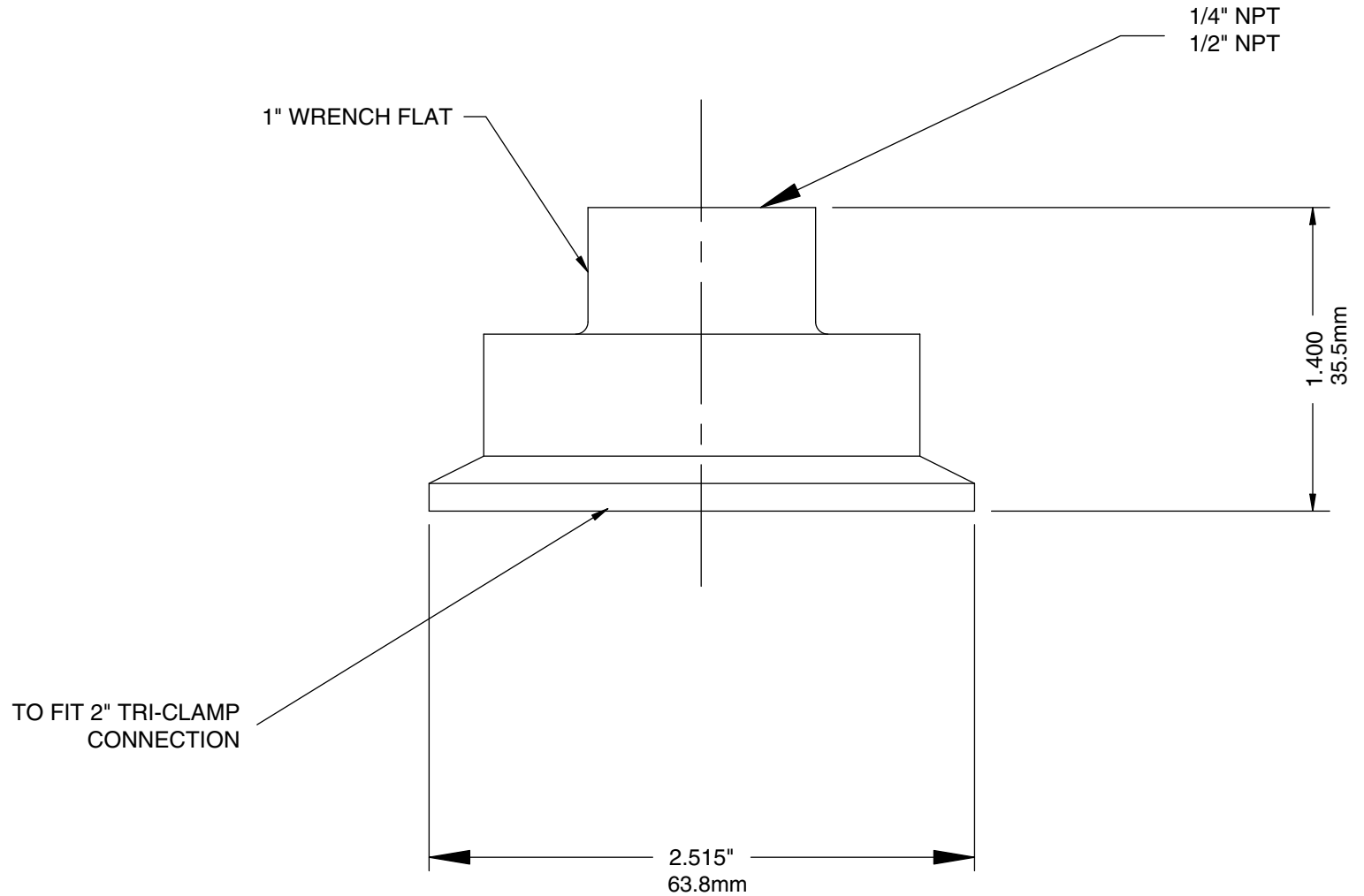

WINTERS INSTRUMENTS

DRAWN BY: E. H.

CHECKED BY:

ENG. APPROVAL:

APPROVED BY:

ALL DIMENSIONS IN INCHES

TOLERANCES
(unless otherwise stated)

Fractional:	1/64"
Decimal:	0.06"

REVISION No. & DATE: APR. 5 2002

TITLE:

2" DIAPHRAGM SEAL #20, 2" TRI-CLAMP

DRAWING NO: DS-20-2.0

Operating Pressure: 1000 / 6000 psi.
 Housing: 316 S/S.
 Diaphragm: 316L S/S.
 Welding: TIG.

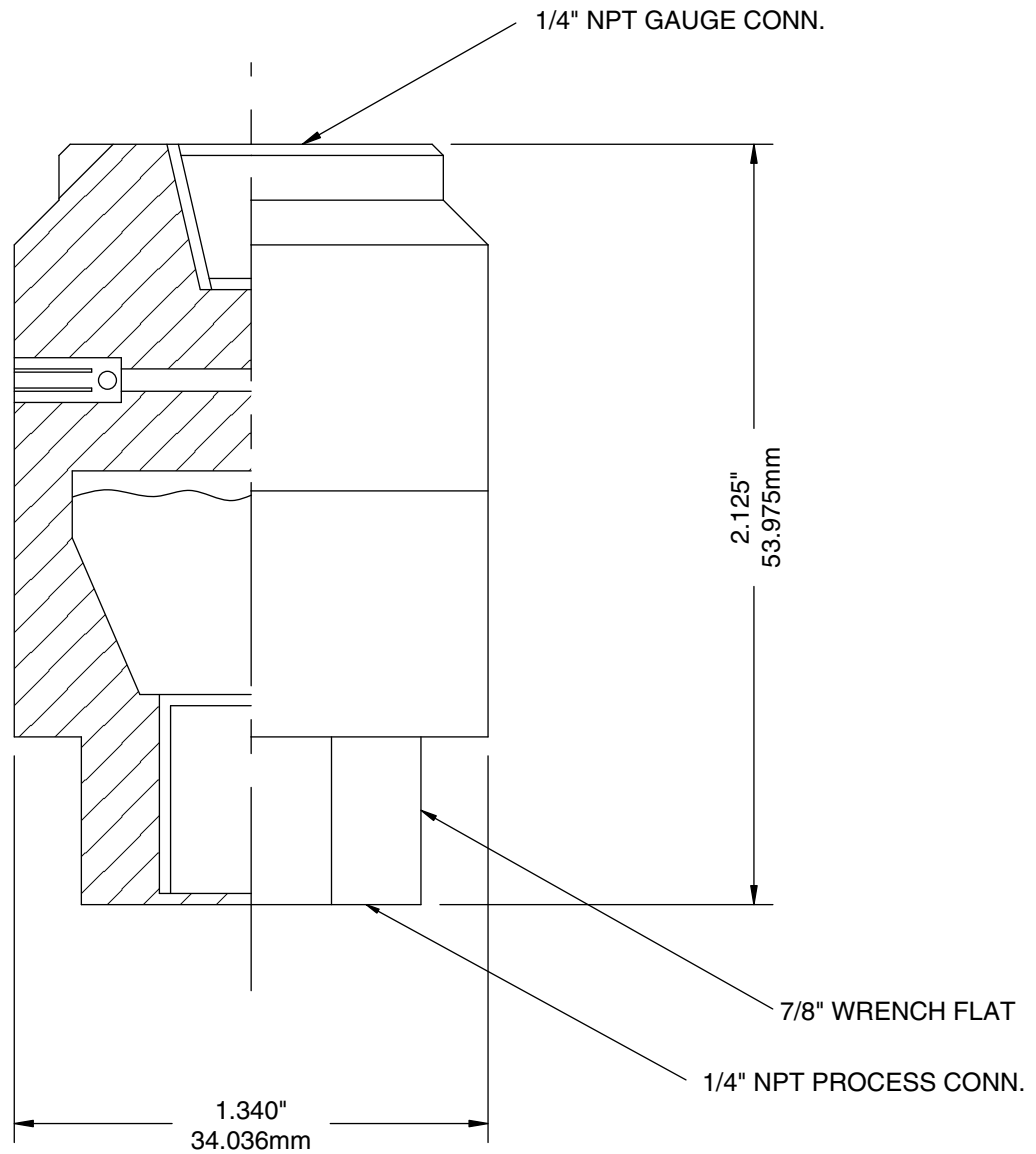

WINTERS INSTRUMENTS

DRAWN BY: E. H.

CHECKED BY:

ENG. APPROVAL:

APPROVED BY:

ALL DIMENSIONS IN INCHES / MM

TOLERANCES
(unless otherwise stated)

Fractional:	1/64"	.4mm
Decimal:	0.06"	1.5mm

REVISION No. & DATE: APR. 5 2002

TITLE:

DIAPHRAGM # 30

DRAWING NO: DS-30

Operating Pressure: 0 / 1000 psi.

Process Temperature: -45°C / 150°C (-49°F / 302°F).

Housing Material: 316 stainless steel.

Diaphragm Material: 316L stainless steel, welded.

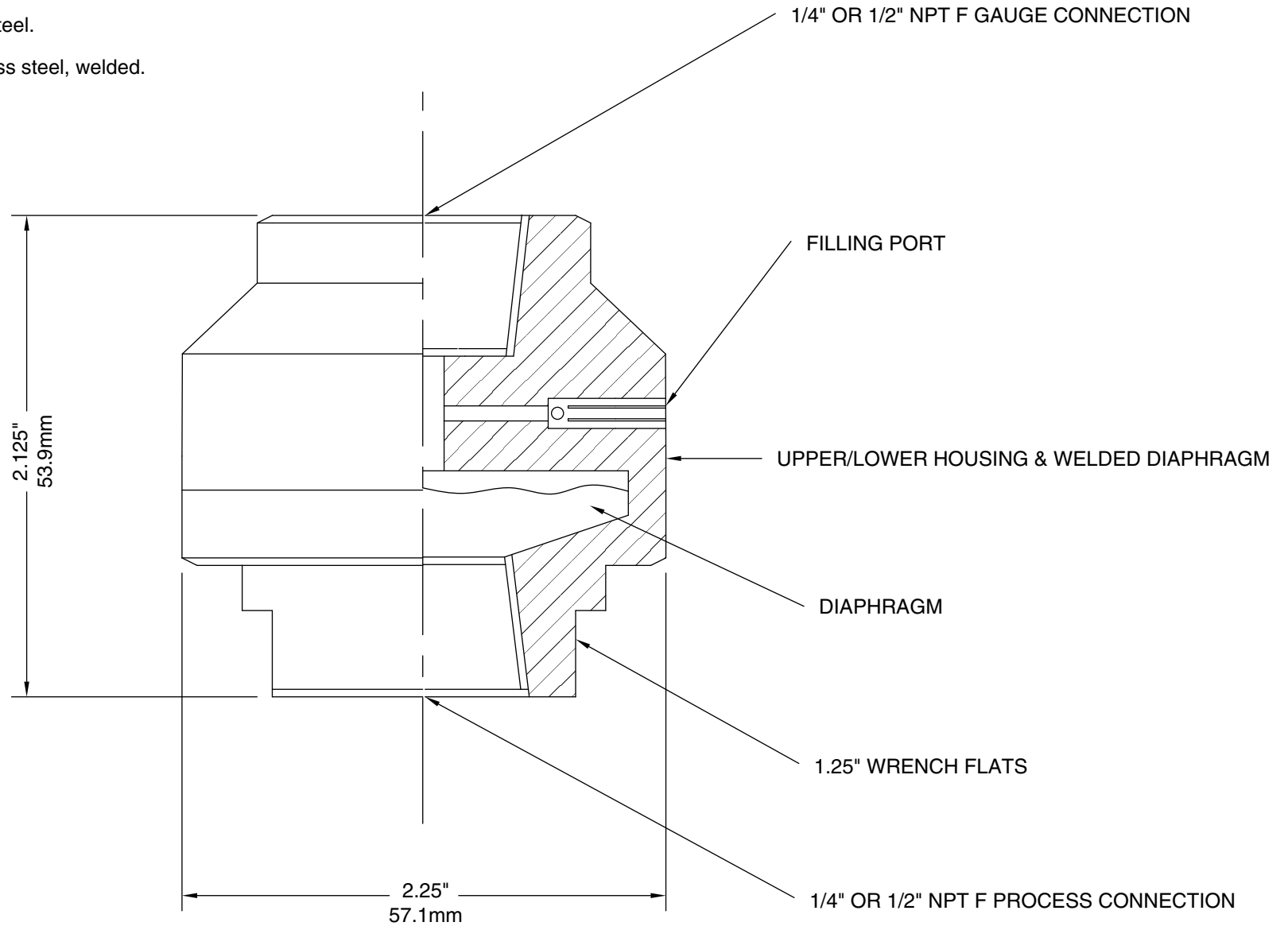

WINTERS INSTRUMENTS

DRAWN BY: E. H.

CHECKED BY:

ENG. APPROVAL:

APPROVED BY:

ALL DIMENSIONS IN INCHES

TOLERANCES
(unless otherwise stated)

Fractional: 1/64"

Decimal: 0.06"

REVISION No. & DATE: APR. 5 2002

TITLE:

DIAPHRAGM # 40

DRAWING NO: DS-40

Operating Pressure: 100 / 1000 psi.

Process Temperature: -45°C / 150°C (-49°F / 302°F).

Housing Material: 316 stainless steel.

Diaphragm Material: 316L stainless steel, welded.

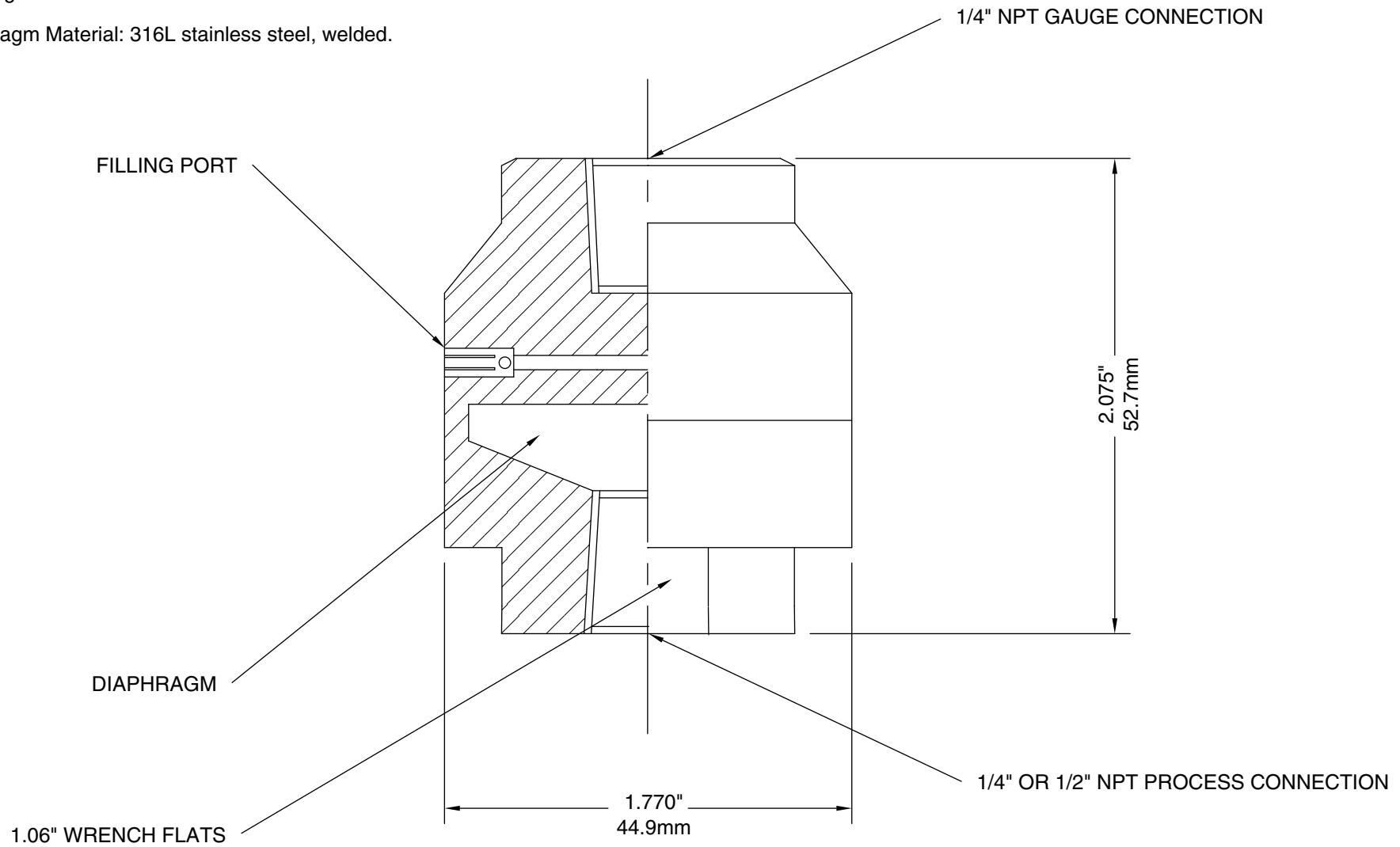

WINTERS INSTRUMENTS

DRAWN BY: E. H.

CHECKED BY:

ENG. APPROVAL:

APPROVED BY:

ALL DIMENSIONS IN INCHES

TOLERANCES
(unless otherwise stated)

Fractional:

1/64"

Decimal:

0.06"

REVISION No. & DATE: APR. 5 2002

TITLE:

DIAPHRAGM # 50

DRAWING NO: DS-50

Process Temperature: minimum -49°F, -45°C, maximum +302°F, +150°C.

Upper Housing: 316 stainless steel

Lower Housing: 316 stainless steel

Diaphragm: 316L stainless steel, welded

Bolts and Nuts: 304 stainless steel.

Gasket: PTFE.

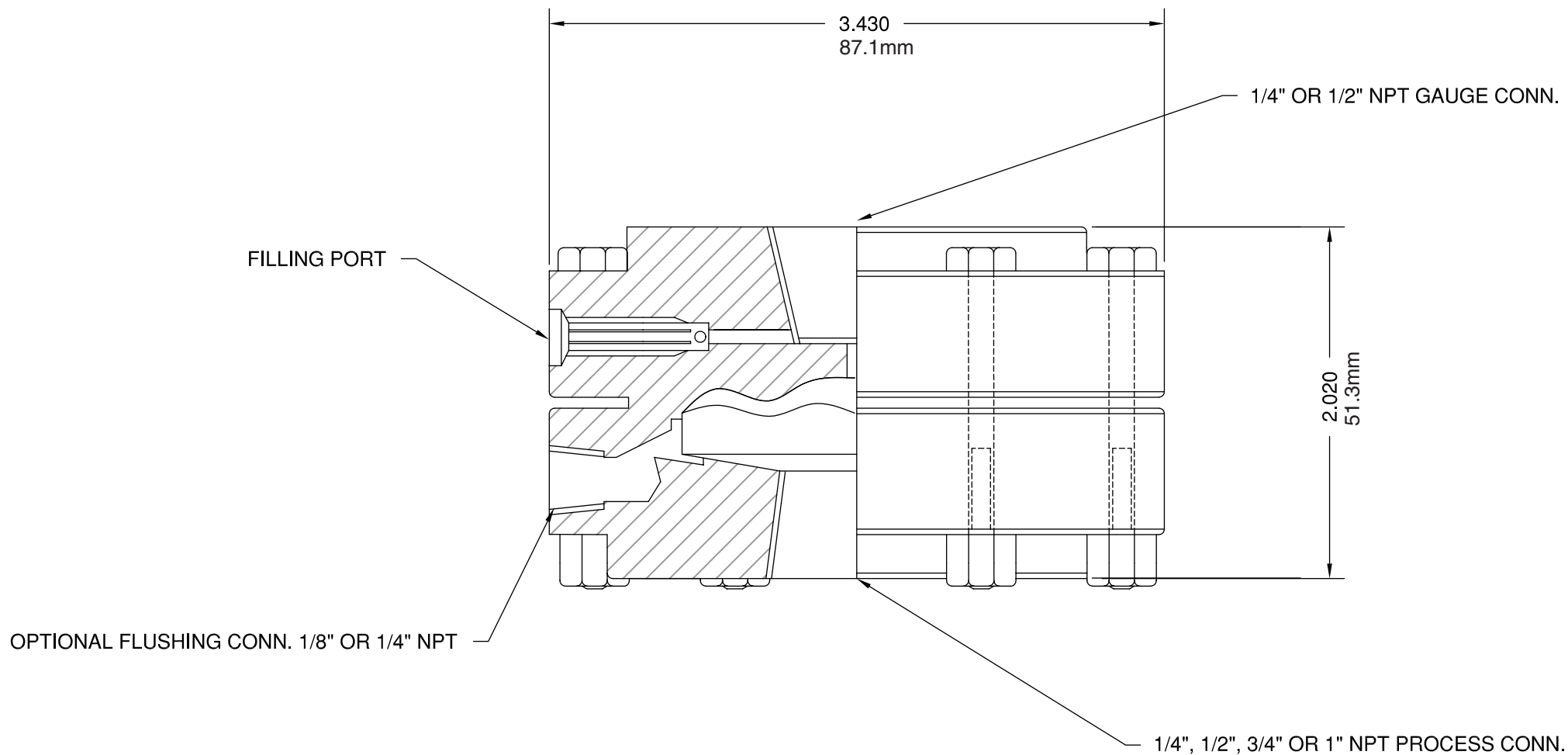

WINTERS INSTRUMENTS

DRAWN BY:

CHECKED BY:

ENG. APPROVAL:

APPROVED BY:

ALL DIMENSIONS IN INCHES

TOLERANCES
(unless otherwise stated)

Fractional: 1/64"

Decimal: 0.06"

REVISION No. & DATE:

TITLE:

DIAPHRAGM # 70

DRAWING NO: DS-70

Operating Pressure: 30" Hg Vacuum / 2500 psi.

Upper Housing Material: 316 stainless steel.

Lower Housing Material: Hastelloy C.

Diaphragm Material: Hastelloy C, welded.

Bolts and Nuts: 304 stainless steel.

Gasket: PTFE.

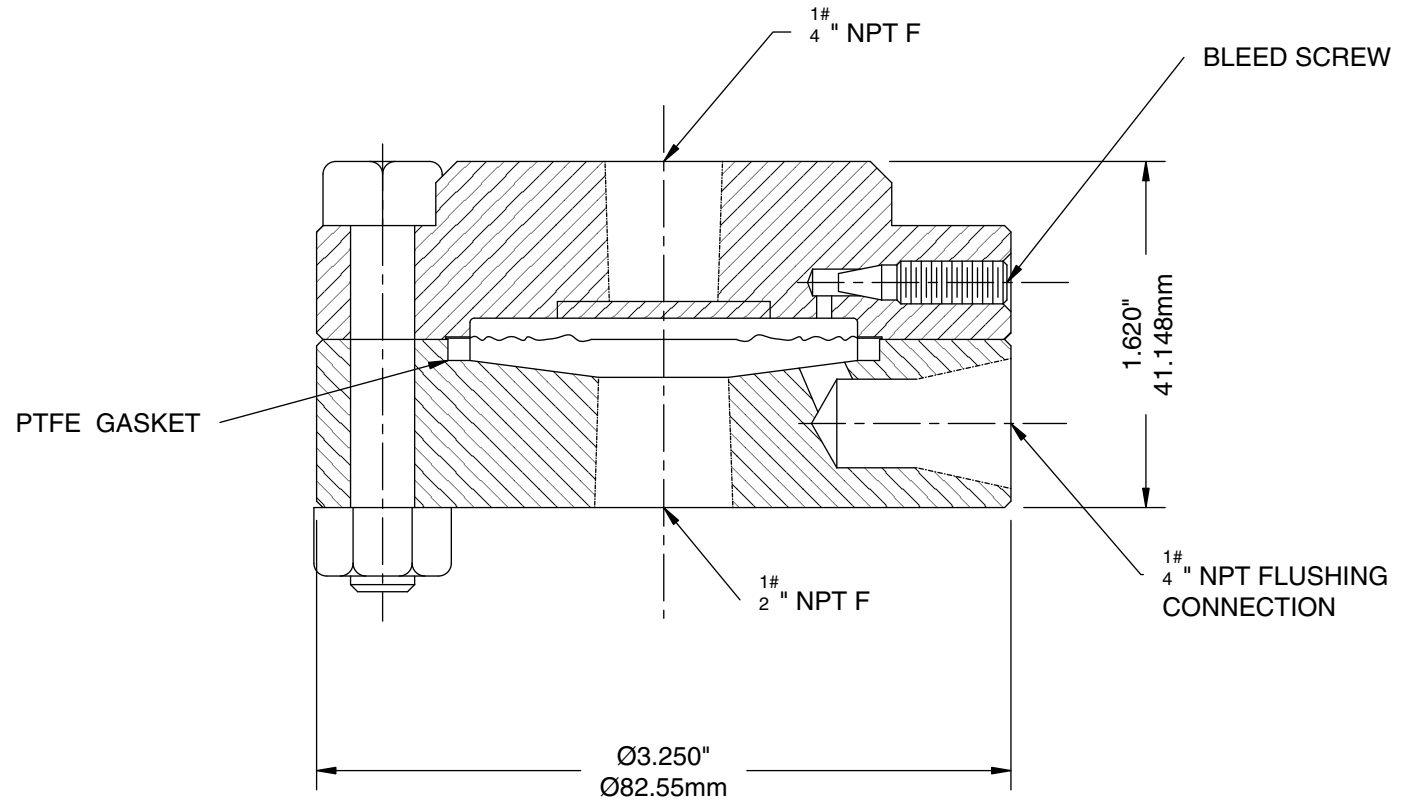

WINTERS INSTRUMENTS

DRAWN BY: E. H.

CHECKED BY:

ENG. APPROVAL:

APPROVED BY:

ALL DIMENSIONS IN INCHES / MM

TOLERANCES
(unless otherwise stated)

Fractional:	1/64"	.4mm
Decimal:	0.06"	1.5mm

REVISION No. & DATE: MAY 02, 2002

TITLE:

#70, 316 S/S UPPER, HASTELLOY C DIAPHRAGM AND LOWER WITH OPTIONAL 1/4 " NPT FLUSHING CONNECTION

DRAWING NO: DS-70-D950HASC-D957HASC

Upper Housing Material: Nickle plated carbon steel.
 Lower Housing Material (Adaptor Ring): 316 stainless steel.
 Diaphragm Material: 316L stainless steel, welded.
 Gasket: PTFE.

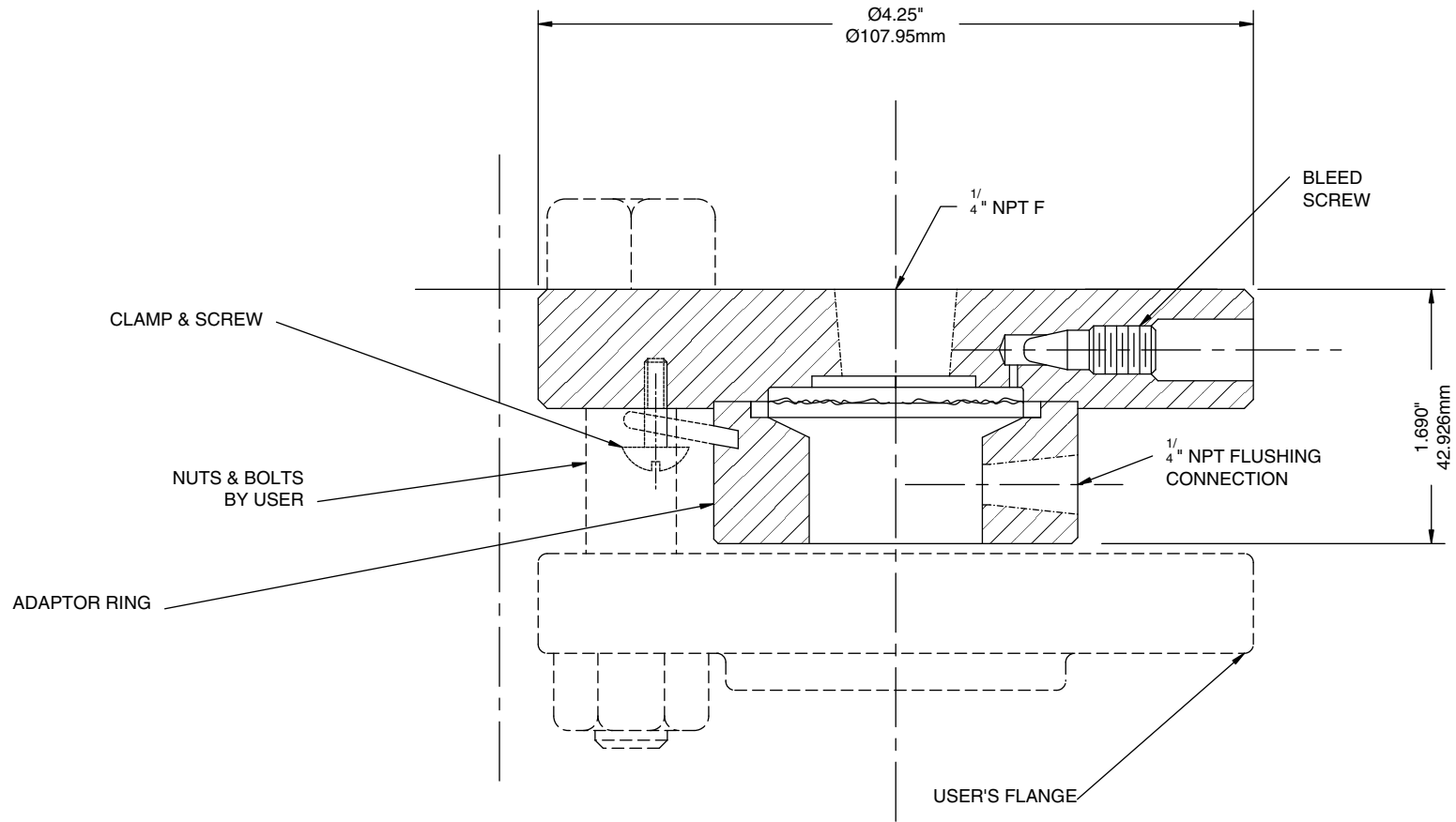

ADAPTOR RING IS CLAMPED BY THE CLAMP AND CLAMP SCREW AT TWO PLACES FOR SHIPPING AND HANDLING. THE CLAMPS CAN REMAIN IN POSITION OR BE DETACHED BY USER JUST PRIOR TO INSTALLATION.



WINTERS INSTRUMENTS

DRAWN BY: E. H.

CHECKED BY:

ENG. APPROVAL:

APPROVED BY:

ALL DIMENSIONS IN INCHES / MM

TOLERANCES
(unless otherwise stated)

Fractional:	1/64"	.4mm
Decimal:	0.06"	1.5mm

REVISION No. & DATE: MAY 02, 2002

TITLE:

#80, 1" 150# RF, 316 S/S DIAPHRAGM AND LOWER WITH
 OPTIONAL FLUSHING CONNECTION

DRAWING NO: DS-80-D1150SS5CS

Upper Housing Material: Nickle plated carbon steel.
 Lower Housing Material (Adaptor Ring): 316 stainless steel.
 Diaphragm Material: 316L stainless steel, welded.
 Gasket: PTFE.

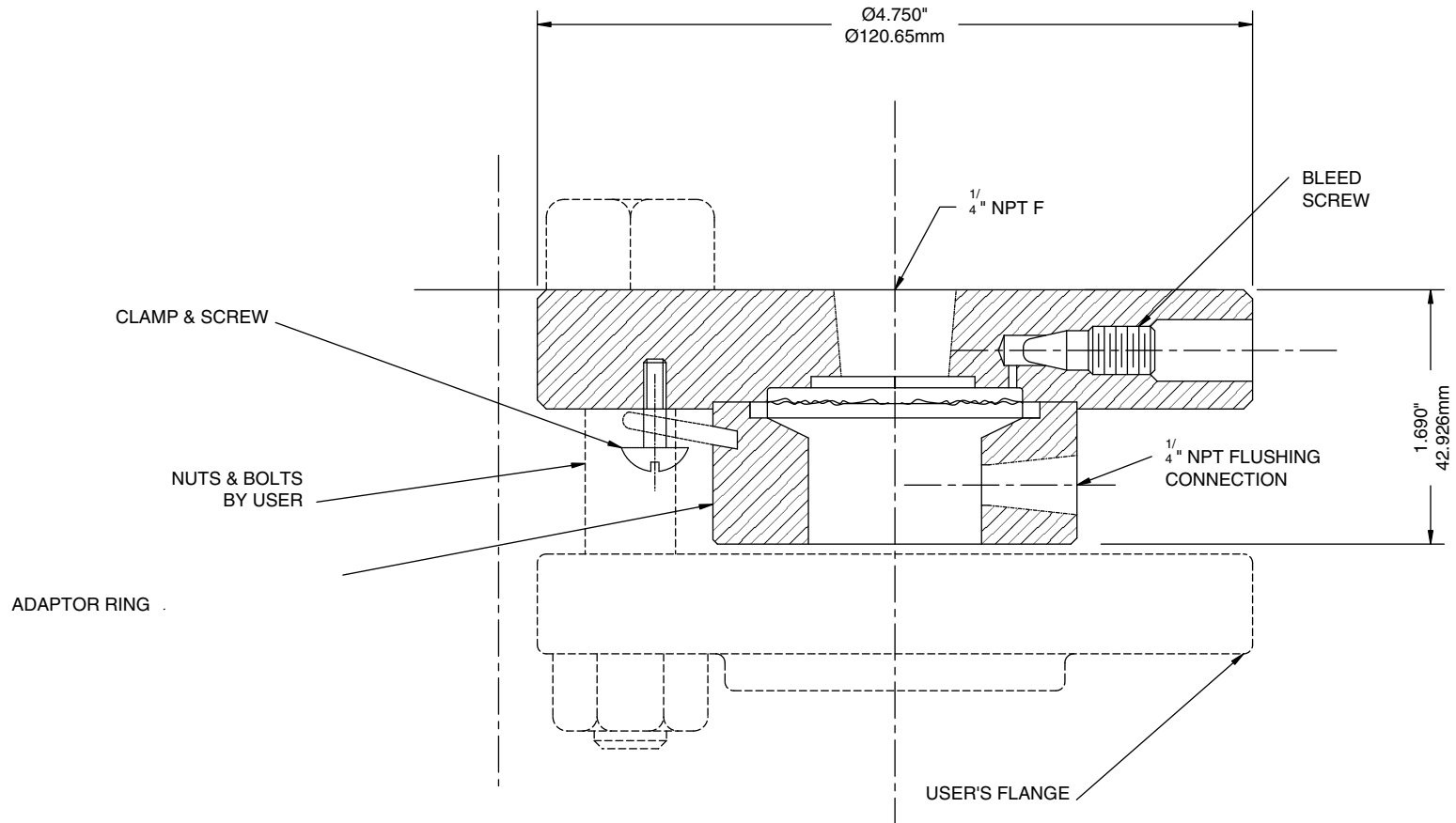

ADAPTOR RING IS CLAMPED BY THE CLAMP AND CLAMP SCREW AT TWO PLACES FOR SHIPPING AND HANDLING. THE CLAMPS CAN REMAIN IN POSITION OR BE DETACHED BY USER JUST PRIOR TO INSTALLATION.



WINTERS INSTRUMENTS

DRAWN BY: E. H.

CHECKED BY:

ENG. APPROVAL:

APPROVED BY:

ALL DIMENSIONS IN INCHES / MM

TOLERANCES
(unless otherwise stated)

Fractional:	$1/64''$.4mm
Decimal:	0.06"	1.5mm

REVISION No. & DATE: MAY 02, 2002

TITLE:

#80, 1" 300# RF, 316 S/S DIAPHRAGM AND LOWER WITH
 OPTIONAL FLUSHING CONNECTION

DRAWING NO: DS-80-D1300SS5CS

Upper Housing Material: Nickle plated carbon steel.
 Lower Housing Material (Adaptor Ring): 316 stainless steel.
 Diaphragm Material: 316L stainless steel, welded.
 Gasket: PTFE.

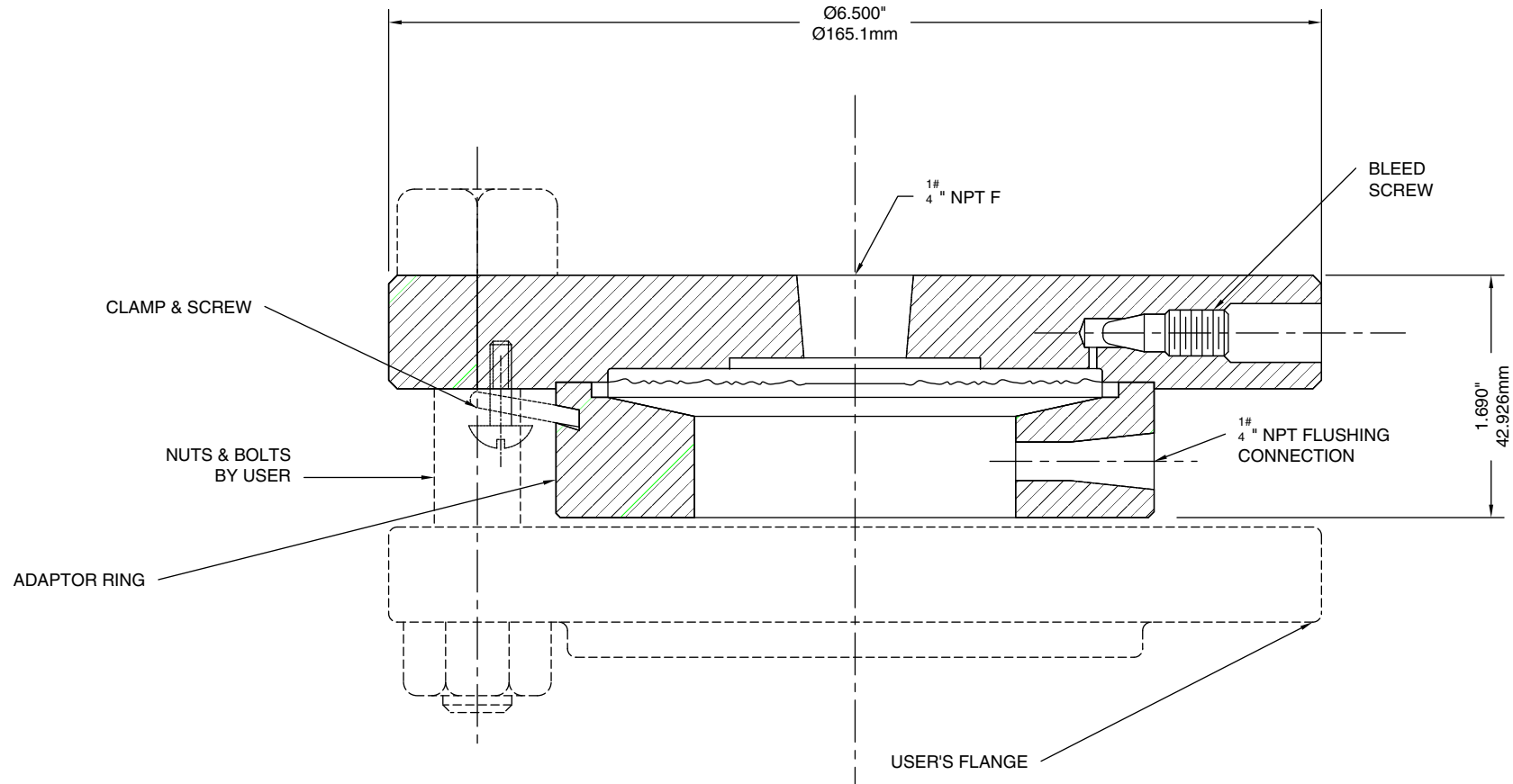

ADAPTOR RING IS CLAMPED BY THE CLAMP AND CLAMP SCREW AT TWO PLACES FOR SHIPPING AND HANDLING. THE CLAMPS CAN REMAIN IN POSITION OR BE DETACHED BY USER JUST PRIOR TO INSTALLATION.



WINTERS INSTRUMENTS

DRAWN BY: E. H.	ALL DIMENSIONS IN INCHES / MM		TITLE: #80, 2" 300# RF, 316 S/S DIAPHRAGM AND LOWER WITH OPTIONAL FLUSHING CONNECTION
	CHECKED BY:	TOLERANCES (unless otherwise stated)	
	ENG. APPROVAL:	Fractional: 1/64" .4mm Decimal: 0.06" 1.5mm	
	APPROVED BY:	REVISION No. & DATE: MAY 02, 2002	
			DRAWING NO: DS-80-D2300SS5CS

Process Temperature: minimum -49°F, -45°C, maximum +302°F, +150°C.

Upper Housing: 316 stainless steel

Lower Housing: 316 stainless steel

Diaphragm: 316L stainless steel, welded

Bolts and Nuts: 304 stainless steel.

Gasket: PTFE.

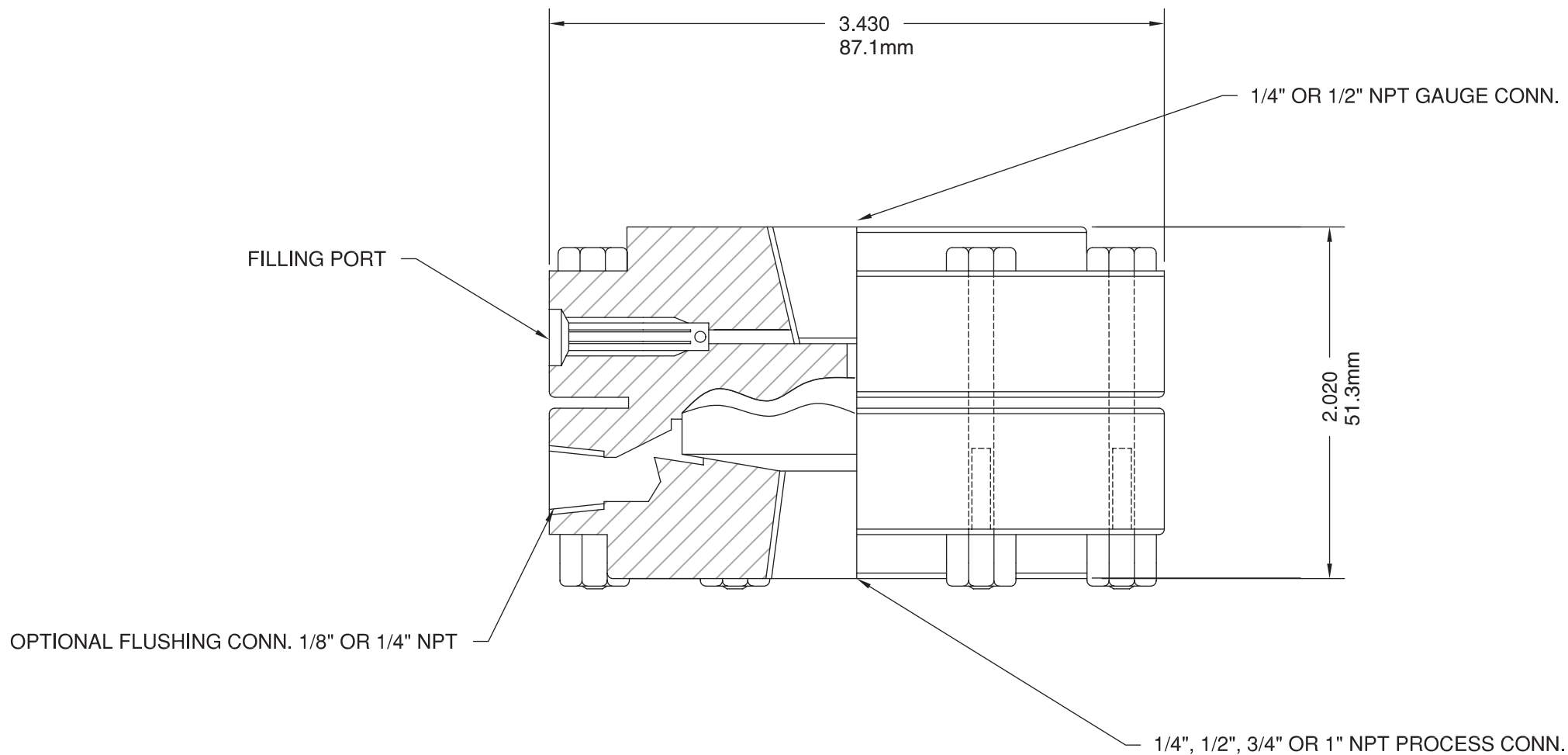

WINTERS INSTRUMENTS

DRAWN BY:

CHECKED BY:

ENG. APPROVAL:

APPROVED BY:

ALL DIMENSIONS IN INCHES

TOLERANCES
(unless otherwise stated)

Fractional:

1/64"

Decimal:

0.06"

REVISION No. & DATE:

TITLE:

DIAPHRAGM # 70

DRAWING NO: DS-70